

# KENLI®

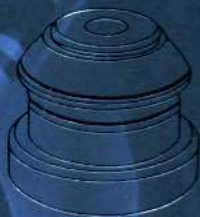

■ Bottom Bracket



■ Head Set



■ Crank Set



■ Repair Tools

**KENLI AXLES CO.,LTD.**



**2018-2019**  
PRODUCT CONTENTS

## KL-B206

EC34/28.6-26T EC34/30



NO	PART NAME	MATERIAL	SPECIFICATION	QUANTITY
1	Lock Nut	Carbon Steel	1-1/8"	1
2	Washer	Steel	2mm	1
3	Top Cone	Carbon Steel	28.6mm	1
4	Cup	Carbon Steel	Φ34mm	2
5	Ball Retainer	Carbon Steel	5/32" X 22	2
6	Seal Ring	Nylon	-	1
7	Lower Cone	Carbon Steel	Φ30mm	1

Height: 38mm Finish: CP/ED

## KL-B207

EC34/28.6 EC34/30



NO	PART NAME	MATERIAL	SPECIFICATION	QUANTITY
1	Start Nut	Alloy 6061	1-1/8"	1
2	Washer	Steel	2mm	1
3	Compress Ring	Nylon	-	1
4	Top Cone	Carbon Steel	1-1/8"	1
5	Ball Retainer	Carbon Steel	5/32" X 22	2
6	Cup	Carbon Steel	Φ34mm	2
7	Seal Ring	Nylon	-	1
8	Lower Cone	Carbon Steel	Φ30mm	1

Height: 26mm Finish: CP/ED

## KL-B207A

EC30/25.4 EC30/27



NO	PART NAME	MATERIAL	SPECIFICATION	QUANTITY
1	Start Nut	Alloy 6061	1"	1
2	Compress Ring	Nylon	1"	1
3	Top Cone	Carbon Steel	1"	1
4	Ball Retainer	Carbon Steel	5/32" X 16	2
5	Cup	Carbon Steel	Φ30mm	2
6	Lower Cone	Carbon Steel	Φ27mm	1

Height: 25.5+0.1mm Finish: CP/ED

## KL-B208

EC34/28.6 EC34/30



NO	PART NAME	MATERIAL	SPECIFICATION	QUANTITY
1	Start Nut	Alloy 6061	1-1/8"	1
2	Upper Cover	Alloy 6061	28.6mm	1
3	Compress Ring	Alloy 6061	28.6mm	1
4	Bearing	G-Cr15	41 X 30.15 X 7 mm x 45°	2
5	Top Cup	Carbon Steel	Φ34mm	1
6	Lower Cup	Carbon Steel	Φ34mm	1
7	Lower Cone	Carbon Steel	Φ30mm	1

Height: 29.5mm                      Finish: CP/ED

## KL-B219

EC34/28.6 EC34/30



NO	PART NAME	MATERIAL	SPECIFICATION	QUANTITY
1	Start Nut	Alloy 6061	1-1/8"	1
2	Compress Ring	Nylon	1-1/8"	1
3	Top Cone	Carbon Steel	-	1
4	Seal Ring	Nylon	-	2
5	Ball Retainer	Carbon Steel	5/32" X 22	2
6	Cup	Carbon Steel	Φ34mm	2
7	Lower Cone	Carbon Steel	Φ30mm	1

Height: 23mm                      Finish: CP/ED

## KL-B236

EC34/28.6 EC34/30



NO	PART NAME	MATERIAL	SPECIFICATION	QUANTITY
1	Start Nut	Alloy 6061	1-1/8"	1
2	Upper Cover	Alloy 6061	1-1/8"	1
3	Compress Ring	Alloy 6061	1-1/8"	1
4	Bearing	G-Cr15	39 X 30 X 6.5mm X 45°	2
5	Cup	Alloy 6061	Φ34mm	2
6	Lower Cone	Alloy 6061	Φ30mm	1

Height: 25.5+0.1mm                      Finish: Anodizing

## KL-B236A

EC30/25.4 EC30/27



NO	PART NAME	MATERIAL	SPECIFICATION	QUANTITY
1	Start Nut	Alloy 6061	25.4mm	1
2	Upper Cover	Alloy 6061	25.4mm	1
3	Compress Ring	Alloy 6061	25.4mm	1
4	Bearing	G-Cr15	38 X 27 X 6.3mm X 45°	2
5	Cup	Alloy 6061	Φ30mm	2
6	Lower Cone	Alloy 6061	Φ27mm	1
			Height: 25.5mm	Finish: Anodizing

## KL-B240

IS44/28.6 EC44/40



NO	PART NAME	MATERIAL	SPECIFICATION	QUANTITY
1	Start Nut	Alloy 6061	1-1/8"	1
2	Top Cone	Alloy 6061	1-1/8"	1
3	Compress Ring	Alloy 6061	1-1/8"	1
4	Bearing	G-Cr15	41 X 30.15 X 7mm X45°	1
5	Top Cup	Alloy 6061	44mm	1
6	Lower Cup	Alloy 6061	44mm	1
7	Bearing	G-Cr15	52 X 40 X 8mm X 45°	1
8	Lower Cone	Alloy 6061	39.8mm	1
			Height: 39mm	Finish: Anodizing

## KL-B241

EC49.7/38.1 EC49.7/40



NO	PART NAME	MATERIAL	SPECIFICATION	QUANTITY
1	Start Nut	Alloy 6061	1-1/2"	1
2	Upper Cover	Alloy 6061	38.1mm	1
3	Compress Ring	Alloy 6061	38.1mm	1
4	Bearing	G-Cr15	52 X 40 X 8mm X45°	2
5	Top Cup	Alloy 6061	49.7mm	1
6	Lower Cup	Alloy 6061	49.7mm	1
7	Lower Cone	Alloy 6061	39.8mm	1
			Height: 40+0.1mm	Finish: Anodizing

## KL-B241A

EC49.7/28.6 EC49.7/33

Head set



NO	PART NAME	MATERIAL	SPECIFICATION	QUANTITY
1	Start Nut	Alloy 6061	1-1/8"	1
2	Upper Cover	Alloy 6061	28.6mm	1
3	Top Cone	Alloy 6061	28.6mm	1
4	Bearing	G-Cr15	52 X 40 X 8mm X 45°	2
5	Top Cup	Alloy 6061	49.7mm	1
6	Lower Cup	Alloy 6061	49.7mm	1
7	Lower Cone	Alloy 6061	33mm	1

Height: 40±0.1mm

Finish: Anodizing

## KL-B242

EC30/25.4 EC30/27



NO	PART NAME	MATERIAL	SPECIFICATION	QUANTITY
1	Start Nut	Alloy 6061	1"	1
2	Top Cone	Alloy 6061	25.4mm	1
3	Compress Ring	Alloy 6061	25.4mm	1
4	Bearing	G-Cr15	38 X 27 X 6.3mm X 45°	2
5	Cup	Alloy 6061	30mm	2
6	Lower Cone	Alloy 6061	27mm	1

Height: 28.5mm

Finish: Anodizing

## KL-B245

EC44/25.4 EC44/27



NO	PART NAME	MATERIAL	SPECIFICATION	QUANTITY
1	Start Nut	Alloy 6061	1"	1
2	Top Cone	Alloy 6061	25.4mm	1
3	Compress Ring	Alloy 6061	25.4mm	1
4	Bearing	G-Cr15	52 X 40 X 8mm X 45°	2
5	Cup	Alloy 6061	44mm	2
6	Lower Cone	Alloy 6061	27mm	1

Height: 25mm

Finish: Anodizing

## KL-8800Y-19



Des.: Two pieces Cr-Mo crank set.  
Φ31.8mm square shape arm.  
Flush machined chainwheel interface.  
Rirht side drive available.

Axle: 48T-19mm  
Bearing: Φ41.28x19x11mm x2pcs  
Length: 175mm  
Finish: ED

Bmx-crank set

## KL-8800Y-22



Des.: Two pieces Cr-Mo crank set.  
Φ31.8mm square shape arm.  
Flush machined chainwheel interface.  
Rirht side drive available.

Axle: Hollow axle 48T-22  
Bearing: Φ41.28x22x11mm x2pcs  
Length: 175mm  
Finish: ED

## KL-8800Y-24



Des.: Two pieces Cr-Mo crank set.  
Φ31.8mm square shape arm.  
Flush machined chainwheel interface.  
Rirht side drive available.

Axle: Hollow axle 48T-24  
Cup OD: Φ51.5mm  
Bearing: Φ41.28x24x11mm x2pcs  
Length: 175mm  
Finish: ED

## KL-06B

6T-18.5mm



Des.: Chaining Outside  
Cr-Mo cold forged spindle  
Flush machined chainwheel interface

Axle: 6T, M8 x1  
Cup OD:  $\Phi$ 51.5mm. Loose B.B Set  
Ball retainer: 5/16"x9 x 2pc  
Finish: BK

## KL-8606



Des.: Three pieces crank set.  
Forged arms, with one-pinch bolt.  
Flush machined chainwheel interface.  
Left side drive available.

Arm: Cr-Mo, 6T  
Length: 170/175mm  
Finish: ED

## KL-10

8T-19mm



Des.: Chaining Inside  
Cr-Mo cold forged spindle  
Flush machined chainwheel interface

Axle: 8T, M8 x1  
Cup OD:  $\Phi$ 51.5mm. Loose B.B Set  
Ball retainer: 5/16"x12 x 2pc  
Finish: BK

## KL-8600



Des.: Three pieces crank set.  
Forged arms, with one-pinch bolt.  
Flush machined chainwheel interface.  
Left side drive available.

Arm: Cr-Mo, 8T  
Length: 170/175mm  
Finish: ED

## KL-10C

8T-19mm



Des.: Chaining Outside  
Cr-Mo cold forged spindle  
Flush machined chainwheel interface

Axle: 8T, M8 x1  
Cup OD:  $\Phi$ 51.5mm. American Loose B.B Set  
Ball retainer: 5/16"x12 x 2pc  
Finish: BK

## KL-8901R-A



Des.: Three pieces crank set.  
 $\Phi$ 28.6mm round shape arm with pin type.  
Flush machined chainwheel interface.  
Left side drive available.

Arm: Cr-Mo, 8T  
Length: 170/175mm  
Finish: ED

## KL-06C

8T-19mm



Des.: Euro Sealed Bottom Bracket.  
Cr-Mo cold forged spindle.  
Alloy cup. Tube spacers.  
Adaptor. Screws.

Axle: 8T-19mm  
Cup Thread: BC1.37"x24T L/R  
Bearing:  $\Phi 31 \times 19 \times 7$ mm x4pcs  
Finish: BK

## KL-06D

8T-19mm



Des.: Spanish Sealed Bottom Bracket.  
Cr-Mo cold forged spindle.  
Cone Washer. Tube spacers.  
Adaptor. Screws.

Axle: 8T-19mm  
Bearing:  $\Phi 37 \times 19 \times 9$ mm x2pcs  
Finish: BK

## KL-06DX

8T-19mm



Des.: Mid Sealed Bottom Bracket.  
Cr-Mo cold forged spindle.  
Cone Washer. Tube spacers.  
Adaptor. Screws.

Axle: 8T-19mm  
Bearing:  $\Phi 41.28 \times 19 \times 11$ mm x2pcs  
Finish: BK

## KL-06F

8T-19mm



Des.: American Sealed Bottom Bracket.  
Cr-Mo cold forged spindle.  
Alloy cup. Cone Washer.  
Tube spacers. Adaptor. Screws.

Axle: 8T-19mm  
Cup OD:  $\Phi 51.5$ mm  
Bearing:  $\Phi 41.28 \times 19 \times 11$ mm x2pcs  
Finish: BK

## KL-8901S



Des.: Three pieces crank set.  
 $\Phi 28.6$ mm square shape arm, with one-pinch bolt  
Flush machined chainwheel interface.  
Left side drive available.

Arm: Cr-Mo, 8T-19mm  
Length: 170/175mm  
Finish: ED

## KL-8902S



Des.: Three pieces crank set.  
 $\Phi 31.8$ mm square shape arm, with one-pinch bolt.  
Flush machined chainwheel interface.  
Left side drive available.

Arm: Cr-Mo, 8T-19mm  
Length: 170/175mm  
Finish: ED



## KL-8902R



Des.: Three pieces crank set.  
 Φ31.8mm round shape arm, with one-pinch bolt.  
 Flush machined chainwheel interface.  
 Left side drive available.

Arm: Cr-Mo,8T-19mm  
 Length: 170/175mm  
 Finish: ED

## KL-8903S



Des.: Three pieces crank set. With two screws.  
 Φ31.8mm square shape arm, with one-pinch bolt.  
 Flush machined chainwheel interface.  
 Left side drive available.

Arm: Cr-Mo,8T-19mm  
 Length: 170/175mm  
 Finish: ED

## KL-8903S-E



Des.: Three pieces crank set. With two screws.  
 Φ31.8mm square shape arm.  
 Flush machined chainwheel interface.  
 Micro-drive available.

Arm: Cr-Mo,8T-19mm  
 Length: 170/175mm  
 Finish: ED

## KL-8901S-A



Des.: Three pieces crank set.  
 Φ28.6mm square shape arm with pin type.  
 Flush machined chainwheel interface.  
 Left side drive available.

Arm: Cr-Mo,8T-19mm  
 Length: 170/175mm  
 Finish: ED

## KL-8902S-A



Des.: Three pieces crank set.  
 Φ31.8mm square shape arm with pin type.  
 Flush machined chainwheel interface.  
 Left side drive available.

Arm: Cr-Mo,8T-19mm  
 Length: 170/175mm  
 Finish: ED

## KL-8903S-A



Des.: Three pieces crank set. With two screws.  
 Φ31.8mm square shape arm with pin type.  
 Flush machined chainwheel interface.  
 Left side drive available.

Arm: Cr-Mo,8T-19mm  
 Length: 170/175mm  
 Finish: ED

## KL-11C

48T-19mm



Des.: Euro Sealed Bottom Bracket.  
Cr-Mo cold forged spindle.  
Alloy cup. Tube spacers.  
Adaptor. Screws.

Axle: 48T-19mm  
Cup Thread: 1.37"x24T L/R  
Bearing:  $\Phi 31 \times 19 \times 7$ mm x4pcs  
Finish: BK

## KL-11D

48T-19mm



Des.: Spanish Sealed Bottom Bracket.  
Cr-Mo cold forged spindle.  
Cone Washer. Tube spacers.  
Adaptor. Screws.

Axle: 48T-19mm  
Bearing:  $\Phi 37 \times 19 \times 9$ mm x2pcs  
Finish: BK

## KL-11DX

48T-19mm



Des.: Mid Sealed Bottom Bracket.  
Cr-Mo cold forged spindle.  
Cone Washer. Tube spacers.  
Adaptor. Screws.

Axle: 48T-19mm  
Bearing:  $\Phi 41.28 \times 19 \times 11$ mm x2pcs  
Finish: BK

## KL-11F

48T-19mm



Des.: American Sealed Bottom Bracket.  
Cr-Mo cold forged spindle.  
Alloy cup. Cone Washer.  
Tube spacers. Adaptor. Screws.

Axle: 48T-19mm  
Cup OD:  $\Phi 51.5$ mm  
Bearing:  $\Phi 41.28 \times 19 \times 11$ mm x2pcs  
Finish: BK

## KL-8800S



Des.: Three pieces crank set.  
 $\Phi 28.6$ mm square shape arm.  
Flush machined chainwheel interface.  
Left side drive available.

Arm: Cr-Mo, 48T-19mm  
Length: 170/175/180mm  
Finish: ED

## KL-8800R



Des.: Three pieces crank set.  
 $\Phi 28.6$ mm round shape arm.  
Flush machined chainwheel interface.  
Left side drive available.

Arm: Cr-Mo, 48T-19mm  
Length: 170/175/180mm  
Finish: ED